

From: [Omar Eid](#)
To: [selmiger](#); [Dianne Massa](#)
Cc: [Seth Herkowitz](#)
Subject: RE: Revised Site Plan with delineated detention ponds in River Park
Date: Tuesday, September 6, 2022 12:46:17 PM

Yes, I will drop them off shortly.

Thank you,

Omar Eid



Omar Eid
Hunter Pasteur
248-539-5511
omar@hunterpasteurhomes.com
www.hunterpasteur.com

From: Sally Elmiger <selmiger@cwaplan.com>
Sent: Tuesday, September 6, 2022 12:37 PM
To: Omar Eid <omar@hunterpasteurhomes.com>; Dianne Massa (DMassa@ci.northville.mi.us) <dmassa@ci.northville.mi.us>
Cc: Seth Herkowitz <seth@hunterpasteurhomes.com>
Subject: RE: Revised Site Plan with delineated detention ponds in River Park

Thank you , Omar. Could you please bring 15 paper copies to provide to the Building Department?

Sally

SALLY M. ELMIGER, AICP, LEED AP
PRINCIPAL
CARLISLE/WORTMAN ASSOCIATES, INC.
PH: 734.662.2200
FAX: 734.662.1935
SELMIGER@CWAPLAN.COM
[HTTP://CWAPLAN.COM](http://CWAPLAN.COM)



Please consider the environment before printing this email

From: Omar Eid <omar@hunterpasteurhomes.com>
Sent: Tuesday, September 6, 2022 11:51 AM
To: Dianne Massa (DMassa@ci.northville.mi.us) <dmassa@ci.northville.mi.us>
Cc: Sally Elmiger <selmiger@cwaplan.com>; Seth Herkowitz <seth@hunterpasteurhomes.com>
Subject: Revised Site Plan with delineated detention ponds in River Park

Good morning Dianne, can you please share the attached site plan with the Planning Commission? This site plan has been updated to separate the detention pond area within the river park from the rest of the park space.

Thank you,

Omar Eid



Omar Eid
Hunter Pasteur
248-539-5511
omar@hunterpasteurhomes.com
www.hunterpasteur.com

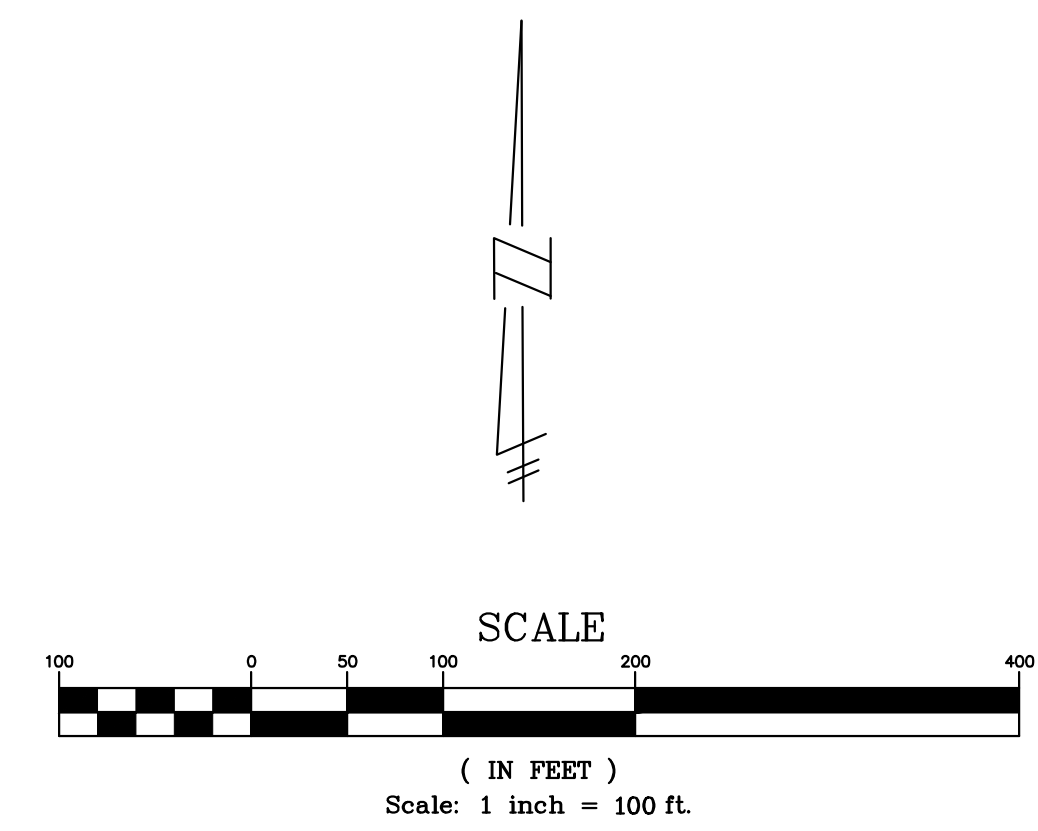
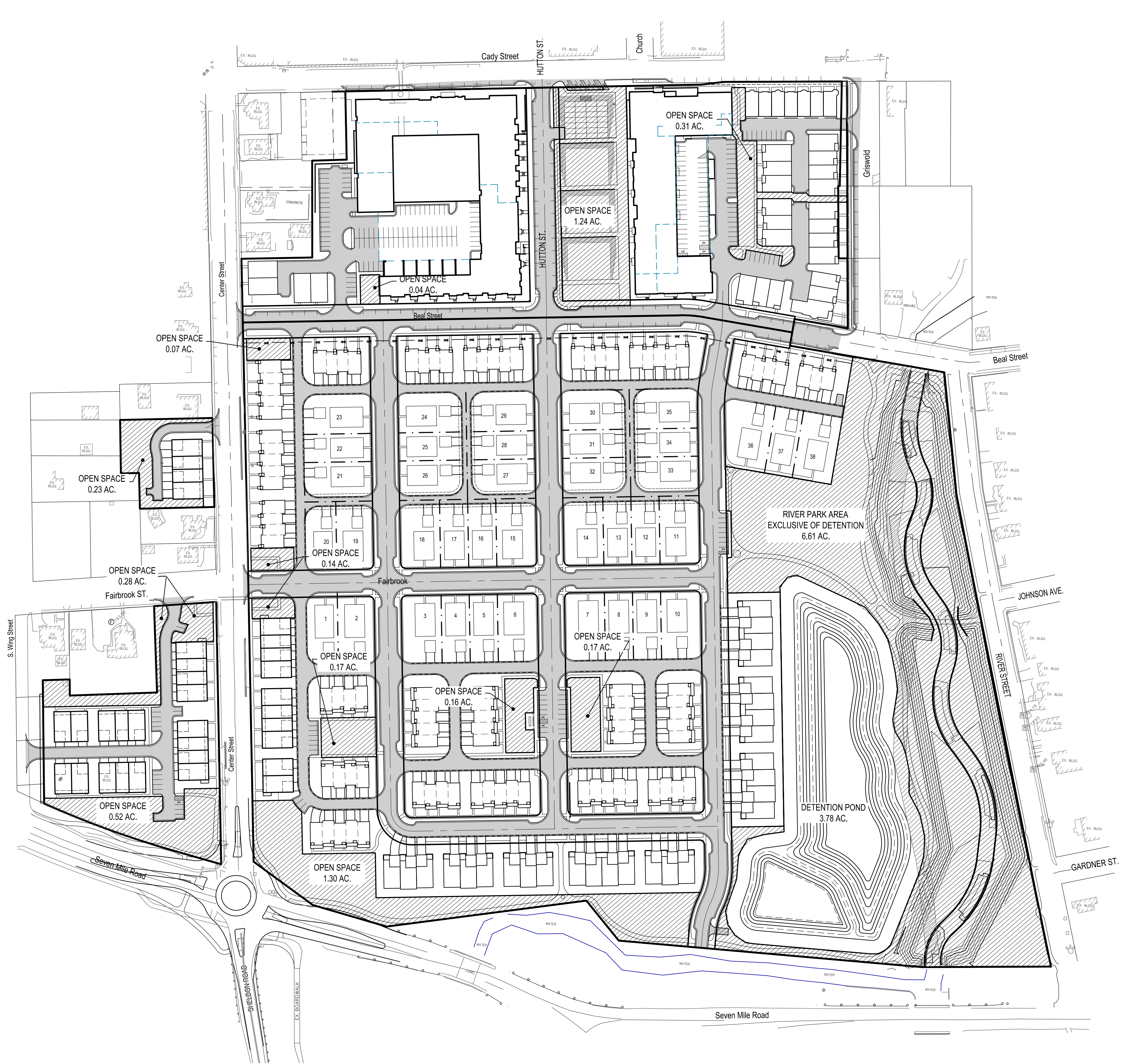

OPEN SPACE SUMMARY	
SITE AREA	48.12 ACRES
OPEN SPACE SHOWN	15.02 ACRES
OPEN SPACE PERCENTAGE	31.21%
OPEN SPACE EXCLUDING DETENTION	11.24 ACRES
OPEN SPACE PERCENTAGE	23.36%

LEGEND	
	EXISTING
	PROPOSED
	PAVEMENT (ASPHALT)
	SIDE WALK (CONCRETE)
	CONCRETE CURB AND GUTTER
	STORM SEWER
	SANITARY SEWER
	WATER MAIN
	MANHOLE
	CATCH BASIN W/STREAM GUARD
	CURB INLET W/SILT SAC
	END SECTION
	GATE VALVE
	HYDRANT
	FLOOD PLAIN
	CONTOURS
	SPOT ELEVATION
	SURFACE DRAINAGE
	OVERFLOW ROUTE
	TREE FENCE ROUTE
	TREE FENCE
	SILT FENCE
	PROPOSED DRIVEWAY LOCATION
	LIMIT OF DISTURBANCE

THE DOWNS
SECTION 3, T1S, R8E, CITY OF NORTHVILLE
WAYNE COUNTY, MICHIGAN

REVISIONS		UTILITY WARNING
NO.	ITEM	DATE
1.	REVISED PER CITY REVIEW	1-20-22
2.	REVISED PER CITY REVIEW	8-9-22
3.	REVISED PER CITY REVIEW	7-1-22
4.	REVISED PER CITY REVIEW	8-9-22

UNDERGROUND UTILITY LOCATIONS AS SHOWN ON THE PLAN, WERE OBTAINED FROM UTILITY OWNER AND NOT FIELD LOCATED.

811 Know what's below.
Call before you dig.

THE CONTRACTOR SHALL BE RESPONSIBLE FOR THE PROTECTION OF AND/OR RELOCATION OF ALL UTILITIES THAT MAY INTERFERE WITH CONSTRUCTION.

DATE: 12-05-21 DESIGNED BY: A.A. JOB NUMBER: 21-001
CHECKED BY: R.E. DRAWING FILE: 10-21001-08.DWG

OPEN SPACE PLAN

SKL SEIBER KEAST LEHNER
ENGINEERING | SURVEYING

39205 COUNTRY CLUB DRIVE, SUITE C8
FARMINGTON HILLS, MI 48331
PHONE: 248.308.3331

SHEET
10

P:\2021\THE DOWNS\THE DOWNS - MAINS\ASB\DWG\MAIN\10-21001-08.DWG 10/2022 10:08 AM