



This fact sheet explains how to meet the City of Burien's Simplified drainage Review requirements. The purpose of these requirements is to provide for mitigation and control of increased runoff and pollution from developed sites.

When is the Simplified Drainage Review required?

- All development, including all redevelopment or new impervious surface, regardless of size, scope and nature that is subject to a City of Burien permit or approval, shall be subject to, at a minimum, the Small Site Drainage Review (BMC 13.10.130) and those projects must meet each of the core requirements set forth in the 2021 King County Surface Water Design Manual (KCSWDM), Appendix C.
- Generally, Simplified Drainage Review is required for any proposed single family residential project that results in any new impervious surface, replaced impervious surface, or new plus replaced impervious surface, or 7,000 square feet or more of land disturbing activity.
- Some projects (e.g., located in critical area) qualifying for Simplified Drainage Review may also require additional data in the form of a Targeted Drainage Review. Please see Section C.1.2. for details about Targeted Drainage Review.

What to submit?

- All projects subject to City Permit and Simplified Drainage Review must submit the following information. The City may require additional supporting information and documents. Sample plans are attached. Please see Section C.1.1 to determine the requirements.
 1. **A Simplified drainage plan**, which includes Flow control BMPs and the components specified in Section C.4 (p. C-137).
 2. **Erosion and sediment control (ESC)** measures to disturbed areas during construction as directed in Section C.1.4 in the **KCSWDM** and Appendix D.
 3. **A written drainage assessment**. This is an overview of the proposed project and its compliance with the drainage requirements of the KCSWDM. It includes a description of proposed site improvements, existing site conditions, critical areas, existing drainage features, and proposed flow control BMPs and ESC measures, including how they were selected and sized. The drainage assessments should also discuss the results and implications of any soils reports or special studies completed for the site.

Useful links and resources

- **2021 King County Surface Water Design Manual (KCSWDM), Appendix C and D:** <http://www.kingcounty.gov/environment/waterandland/stormwater/documents/surface-water-design-manual.aspx> or search using an internet search engine (Google.com, Yahoo.com, etc.)
- **Burien Municipal Code (BMC):** <http://www.codepublishing.com/wa/burien/>

Simplified Drainage Review Requirements



C.4.2 SPECIFICATIONS FOR SITE PLANS

FIGURE C.4.2.A SINGLE FAMILY RESIDENCE – FLOW CONTROL BMP SITE PLAN

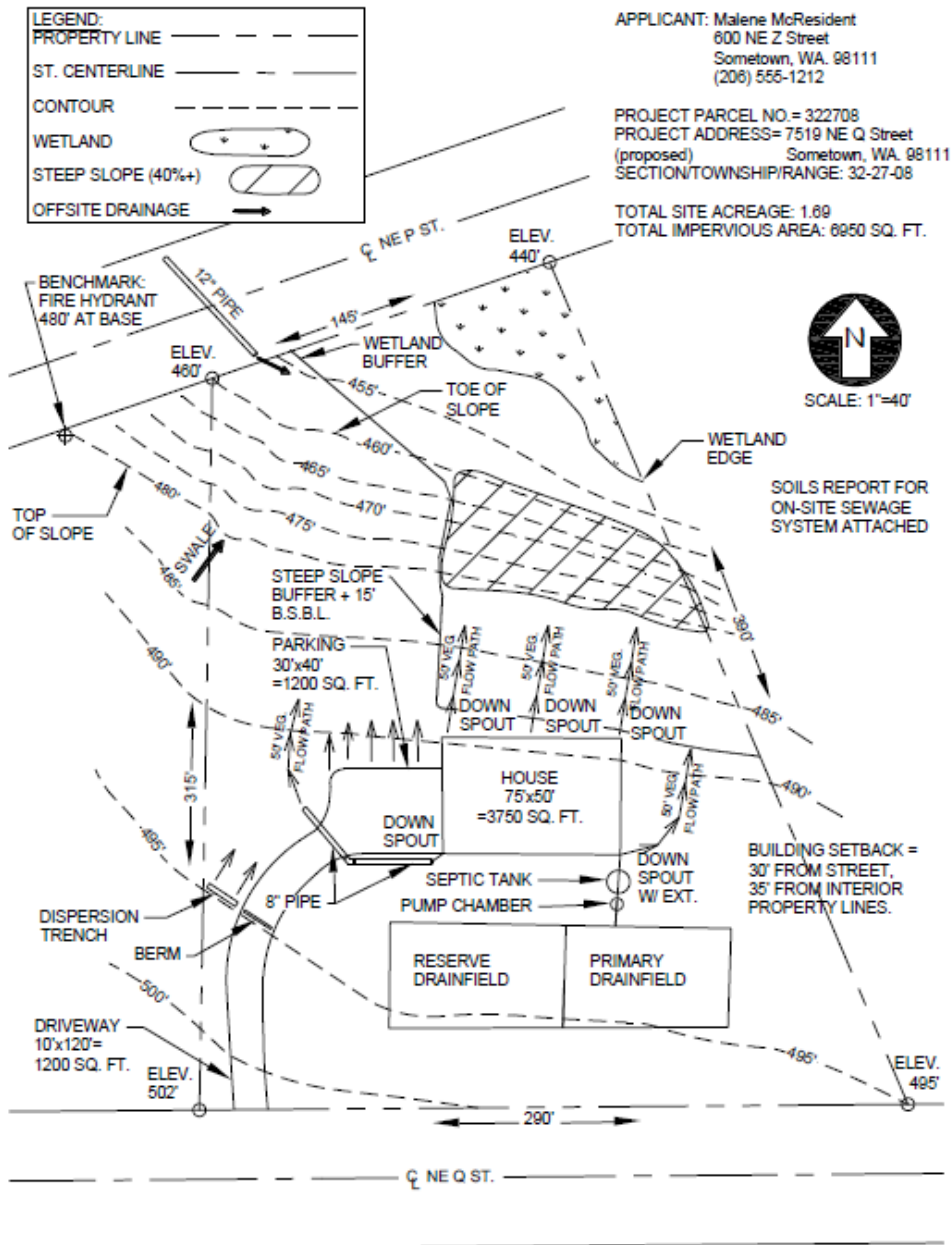

Sample of a small site drainage plan (from 2021 King County Surface Water Design Manual, Appendix C)

SECTION C.4 SIMPLIFIED DRAINAGE PLAN SPECIFICATIONS

FIGURE C.4.2.B SINGLE FAMILY RESIDENCE – SIMPLIFIED SITE CSWPP PLAN

